

Fact Sheet AY 2026-27

Flexible MBA Exchange



WHU – Otto Beisheim School of Management

International Relations Office and post address

International Relations Office
Campus Vallendar
Burgplatz 2
56179 Vallendar
Germany

ir@whu.edu
www.whu.edu/en
www.whu.edu/exchange

Follow us on Social Media:



WHUInternational

WHU Campus Düsseldorf visitor address

WHU Campus Düsseldorf
Erkrather Straße 224a
40233 Düsseldorf
Germany





Administrative Matters

Academic Calendar*

<https://www.whu.edu/programs/exchange-programs/>

Start your MBA Exchange Program any time throughout the year

Customizable Length of Stay:

Due to the modular course structure, MBA exchange students can stay for as little as a few weeks, a full semester or anywhere in between.

During their stay abroad, students can choose from both Part-time MBA courses (offered on Saturdays and Sundays) and Full-time MBA courses as well as the Master in Finance courses (MSc) (on a case by case basis).

MBA Fall 2026

Flexible Semester Dates:

September 01 – December 18, 2026

Orientation:

Will be arranged individually

MBA Spring 2027

Flexible Semester Dates:

January 11 – May 01, 2026

Orientation:

Will be arranged individually

*All dates are subject to change

Recommended Deadlines for Application & Nomination

Fall 2026	June 1, 2026 (recommended**)
Spring 2027	October 1, 2026 (recommended**)
Double Degree	April 1, 2026

** Please let us know if you would like to nominate students after the deadline.

Nomination Procedure

The home university nominates their student(s) via email including the following information:

- First name and family name of the student (as shown in passport)
- Student's gender
- Student's nationality (for visa purposes)
- Intended length of study
- Study program (MBA, MBA Double Degree)***
- Student's email address

*** Due to the different campus locations and program structures, graduate exchange students can not mix MSc and MBA courses, the Master in Finance (MSc) is an exception since this program takes place in Düsseldorf. The partner university should indicate upon nomination whether the nominated graduate student is applying for our MSc Exchange Program on our Vallendar campus (see our WHU Campus Vallendar BSc MSc Fact Sheet) or our MBA Exchange Program on our Düsseldorf Campus (if eligible).



Application Process

After the home university has emailed the nomination to the respective exchange coordinator at WHU, the nominated student(s) will receive instructions for the online application procedure via email.

Shortly after the application deadline, we will process the complete online applications and send an acceptance package including the letter of acceptance for each student to the international office at the home university.

Housing

At the moment WHU cannot offer exchange students university sponsored housing in Düsseldorf. After the application deadline students will be provided additional information and resources which they can use to find housing. It is each student's responsibility to secure accommodation but we are happy to help and give them advice during the process.

Visa and Residence Permit

Depending on their nationality, students might need a visa and/or residence permit to study in Germany. While we assist students in applying for their residence permit, it is the student's own responsibility to take care of visa matters as early as possible, ideally at least 2 months prior to departure.

Students should contact the German Consulate of their home country (or country of residence) to find out if they need a student visa prior to entering Germany/Europe for study purposes.

Health Insurance

All exchange students have to provide proof of health insurance upon their arrival at WHU. It has to cover the following aspects to be acknowledged by the German authorities:

- The student's name has to be mentioned as the insured person
- Period of time: coverage of the entire stay in Germany
- Region: Germany must be covered
- Emergencies must be covered
- All medical expenses must be covered

Health insurance with full coverage for sickness, emergencies and all medical expenses is absolutely mandatory for all exchange students in Germany. Students can contact the International Relations Office at WHU in advance to check if their health insurance is sufficient.

Cost of Living

A student's cost of living will be approximately 1500 euros per month, depending on their lifestyle and how much they're willing to spend on free time activities (e.g. travelling, eating out, sports, visiting concerts and clubs).

- Accommodation: between 400 € and 700 €
- Mobile Phone: approx. 30 €
- Food: approx. 180 €
- Local transportation: 0 € (free semester ticket)
- Health Insurance: approx. 100 € if acquired in Germany
- Miscellaneous (leisure activities): approx. 300 €



Campus in Düsseldorf – MBA Exchange Program

Full-time and Part-time MBA and the Master in Finance (MSc) courses for exchange students are conducted on our campus in Düsseldorf, while the Master in Management (MSc), and Bachelor in International Business Administration (BSc) courses are in Vallendar, as will the European Summer programs.

Graduate students fulfilling the WHU MBA admission requirements (see below) need to decide prior to nomination which program they would like to join. The partner universities should include in their nomination email whether the nominated graduate student will join our MSc (Vallendar), MiF or MBA (Düsseldorf) Exchange Program.

For information on our MSc Exchange Programs, please see our "WHU Campus Vallendar BSc MSc Fact Sheet" and our "WHU MiF Fact Sheet"

For more information on our Campus in Düsseldorf, please visit this website: www.whu.edu/mba-exchange

To "discover Düsseldorf", have a look at this official city website: <https://www.duesseldorf.de/international/tourism/discover.html>

MBA Admission Requirements

MSc and MBA exchange students may apply for our MBA Exchange Program if they fulfill the following admission requirements:

Minimum Age: 24 years

Fulfill one language requirement below:

- English as mother tongue
- Completed or currently studying in a university degree program taught and examined entirely in English
- Minimum internet-based TOEFL score of 100 points
- Minimum 7.0 in IELTS.

Additionally, MSc students wishing to enroll in our MBA Exchange Program need to prove **two years of work experience** (full-time job or full-time internships in Business Administration).

Program Offer for Exchange Students

On its campus in Düsseldorf, WHU graduate exchange students fulfilling the MBA admission requirements can choose classes from the Full-time MBA, Part-time MBA as well as the Master in Finance (MSc) Program.

On its campus in Vallendar, WHU offers a Bachelor in International Business Administration and Bachelor in Business Psychology for undergraduate exchange students, a Master in Entrepreneurship, Master in International Business and a Master

in Business Analytics in addition to the Master in Management program for graduate exchange students (for information on these programs, e.g. academic calendar, see "WHU Campus Vallendar BSc MSc Fact Sheet").

Due to the different campus locations and program structures, **graduate exchange students can no longer mix MSc (Vallendar Campus) and MBA courses, with the exception of the Master in Finance program.**

Course Catalog

<https://ir-online-course-guide.whu.edu/>

Language of Instruction

Our Full-time and Part-time MBA Program is entirely taught and examined in English.

Language Requirements

See "MBA Admission Requirements" on this page.

Academic Information

Class format: Lectures, seminars and exercises

Class size: 20 to 40 students

Examination types: Exams, papers, cases, presentations and participation

Attendance: Mandatory

Workload: 5 to 7 courses per term for all programs

Additional Student Services Available

- Personalized academic counseling
- Access to our award-winning Career Center (e.g. company presentations, networking and recruiting fairs, online job & internship database)
- Free Semester Ticket: access to all public transportation in North Rhine-Westphalia
- Free German language courses offered

WHU Grading System		Definition
1.0 to 1.5	sehr gut	very good
1.6 to 2.5	gut	good
2.6 to 3.5	befriedigend	satisfactory
3.6 to 4.0	ausreichend	sufficient
5.0	nicht ausreichend	fail

Contact

Director of International Relations

Stefanie Schweins

stefanie.schweins@whu.edu
International Partnerships & Agreements
Phone: +49 261 6509 160

Coordinators

Sophie Schulze

sophie.schulze@whu.edu
MBA & MiF Exchange Coordinator (Inbound)
Exchange Coordinator – China, Singapore,
Australia, New Zealand
Online Bachelor Summer Program
Phone: +49 261 6509 164

Pui-Ying (Athena) Chan

pui-ying.chan@whu.edu
Exchange Coordinator – Canada
Bachelor European Summer Program
Phone: +49 261 6509 161

Kristina Schwanitz

kristina.schwanitz@whu.edu
Exchange Coordinator – Europe (BSc.)
Scholarships & Erasmus+ Coordinator
Phone: +49 261 6509 163

Anna Willwacher

anna.willwacher@whu.edu
Exchange Coordinator – Africa, Asia
(except China and Singapore)
Phone: +49 261 6509 165

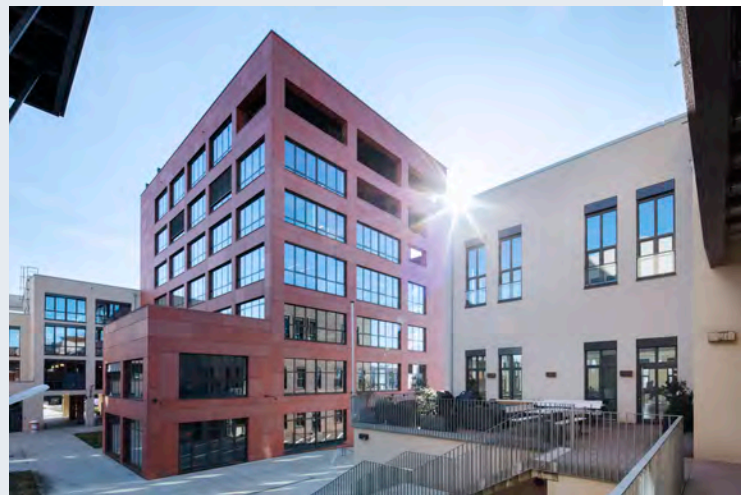

Alyssa Scherer

alyssa.scherer@whu.edu
Exchange Coordinator – Europe (MSc.)
Double Degree & Erasmus+ Coordinator
MBA European Summer Program
Phone: +49 261 6509 166

Wiktorija Engel

wiktorija.engel@whu.edu
Exchange Coordinator - Latin America
Online MBA European Summer Program
Phone: +49 261 6509 167

Punam Khokle

punam.khokle@whu.edu
Exchange Coordinator – USA
International Marketing Coordinator
Phone: +49 261 6509 162

